

# 1. Extension Assembly

## Package contents:

1. extension body 1x
2. extension arm 2x
3. adapter holder 1x
4. arm joint 2x
5. large peg 2x
6. connector washer 4x
7. small peg 2x
8. hand screw 1x
9. split pin 2x
10. nut 4x
11. bolt 4x



Remove all parts from the packaging and insert the arms **2** into extension body **1** and connect it with connector washers **6** nuts **10** and bolts **11** on both sides as displayed on the picture below.

Insert adapter holder **3** into extension body **1**, choose one of the two length options and secure it with hand screw **8**.

Insert arm joints **4** into extension arms **2**, choose one of the four length options and secure it with small pegs **7** and split pins **9**.

Then insert large pegs **5**, which are used to connect the extension to the paddock stand, into the holes at the end of the arm joints **4**.

After connecting the assembled extension to the paddock stand do not forget to secure it with the securing screws of the stand.

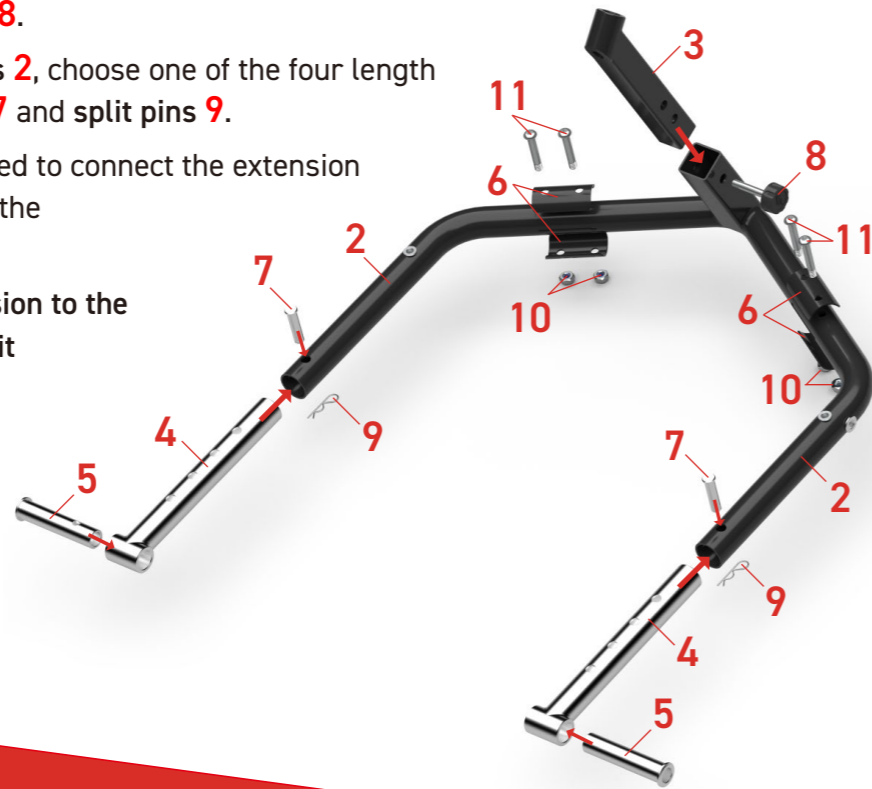

# 1. Extension installation

Front head lift paddock stand extension is compatible with rear Sefis paddock stands.

To install the **extension body** onto the paddock stand as pictured below. Adjust the height and reach of the extension and secure the extension with **split pins** and the paddock stand **securing screw**. Available as an additional purchase is the **maintenance pin**, which screws into the M6 threading on the body of the extension.

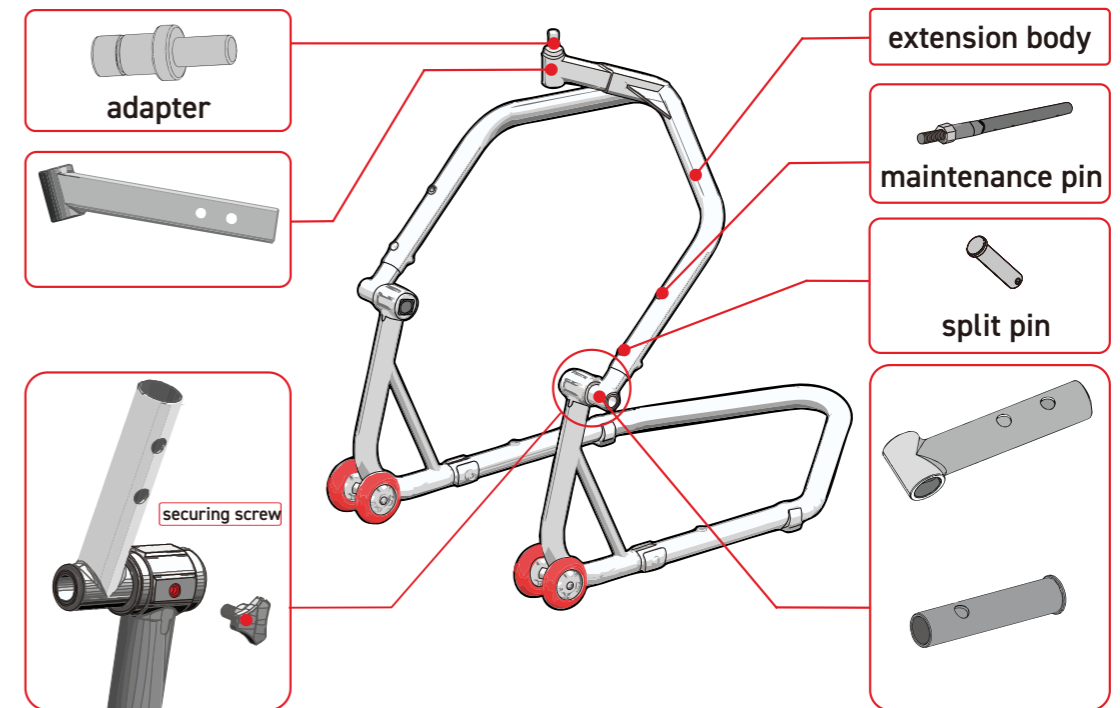

# 2. Use

Choose a fitting **adapter** depending on the diameter of the **front head hole** of the specific motorcycle and insert the **adapter** into the extension body, no further lock-in is needed. It is advised to cover the front fender with a piece of cloth to avoid possible damage in case of careless manipulation. Then move the paddock stand around the front wheel and insert the **adapter** into the **front head hole** of the motorcycle. Once affixed slowly press down the main handle of the paddock stand which will smoothly raise the wheel.



# 3. Warning

When using two paddock stands always lift rear wheel first and then proceed to lift the front wheel. It is advised to not lift motorcycle alone as the safest use is for one person to hold the motorcycle while another person lifts it using the paddock stand. Prior to the use always inspect technical condition of the paddock stand and the adapter set up. Keep away from children when in use.

Maximum carrying capacity of single paddock stand is **200 kg** for maximum motorcycle weight of **400 kg**.

**FRONT HEAD LIFT EXTENSION  
COMPATIBLE WITH SEFIS REAR Paddock STANDS**

**MANUAL EN**

